

# BONGONGO ANGUS SPRING SALE 2024

## SUPPLEMENTARY SHEET

LOT	BULL ID	WEIGHT (kg)	SCROTAL (cm)
1	NGX22T478	812	43
2	NGX22T1443	808	40
3	NGX22T443	746	41
4	NGX22T610	668	42
5	NGX22T391	746	42
6	NGX22T1473	762	39
7	NGX22T700	694	37
8	NGX22T1288	702	38
9	NGX22T444	732	39
10	NGX22T1032	678	39
11	NGX22T653	650	41
12	NGX22T707	662	36
13	NGX22T842	682	42
14	NGX22T666	708	39
15	NGX22T509	740	40
16	NGX22T1498	678	40
17	NGX22T680	648	41
18	NGX22T1369	740	41
19	NGX22T353	688	40
20	NGX22T361	682	36
21	NGX22T967	710	40
22	NGX22T1512	648	38
23	NGX22T675	636	41
24	NGX22T332	636	36
25	NGX22T1374	662	43
26	NGX22T1045	636	38
27	NGX22T688	674	41
28	NGX22T1080	686	40
29	NGX22T814	770	40
30	NGX22T385	664	42
31	NGX22T1228	650	39
32	NGX22T1370	640	41
33	NGX23U170	642	40
34	NGX23U3	642	40
35	NGX23U271	630	38
36	NGX23U91	600	38
37	NGX23U291	658	40 Retain Semen Share
38	NGX23U285	600	41
39	NGX23U19	662	39
40	NGX23U227	634	43
41	NGX23U149	634	40
42	NGX23U352	624	40
43	NGX23U196	560	41
44	NGX23U41	588	38

LOT	BULL ID	WEIGHT (kg)	SCROTAL (cm)
45	NGX23U305	582	37
46	NGX23U198	582	38
47	NGX23U192	544	40
48	NGX23U185	580	41
49	NGX23U211	618	37
50	NGX23U295	596	40
51	NGX23U95	604	38
52	NGX23U289	WITHDRAWN	
53	NGX23U177	596	38
54	NGX23U220	WITHDRAWN	
55	NGX23U1	606	38
56	NGX23U216	546	38
57	NGX23U128	578	40
58	NGX23U308	554	36
59	NGX23U245	582	36
60	NGX23U105	572	41
61	NGX23U74	WITHDRAWN	
62	NGX23U14	WITHDRAWN	
63	NGX23U28	624	40
64	NGX23U351	616	38
65	NGX23U85	606	40
66	NGX23U147	634	38
67	NGX23U159	586	40
68	NGX23U17	566	38
69	NGX23U242	570	38
70	NGX23U8	610	40
71	NGX23U120	578	41
72	NGX23U84	604	34
73	NGX23U119	564	41
74	NGX23U86	552	38
75	NGX23U133	564	38
76	NGX23U240	WITHDRAWN	
77	NGX23U55	550	39
78	NGX23U167	566	37
79	NGX23U278	594	38
80	NGX23U214	538	35
81	NGX23U279	538	40
82	NGX23U300	566	38
83	NGX23U321	582	39
84	NGX23U151	WITHDRAWN	
85	NGX23U99	542	39
86	NGX23U49	604	38
87	NGX23U44	560	38
88	NGX23U353	560	38

# BULL PENS MAP

LOT	BULL ID	WEIGHT (kg)	SCROTAL (cm)
89	NGX23U341	604	41
90	NGX23U346	518	41
91	NGX23U235	556	39
92	NGX23U115	WITHDRAWN	
93	NGX23U25	556	40
94	NGX23U93	WITHDRAWN	
95	NGX23U107	558	38
96	NGX23U292	508	37
97	NGX23U162	558	40
98	NGX23U1531	520	36
99	NGX23U1542	540	38
100	NGX23U1568	514	40
101	NGX23U1553	WITHDRAWN	
102	NGX23U1398	554	39
103	NGX23U1405	552	38
104	NGX23U1374	528	39
105	NGX23U378	518	39
106	NGX23U616	546	39
107	NGX23U372	510	38
108	NGX23U1493	552	37
109	NGX23U1519	500	36
110	NGX23U618	494	37
111	NGX23U1436	498	39
112	NGX23U1700	524	40
113	NGX23U1413	508	34
114	NGX23U1634	514	35
115	NGX23U603	530	39

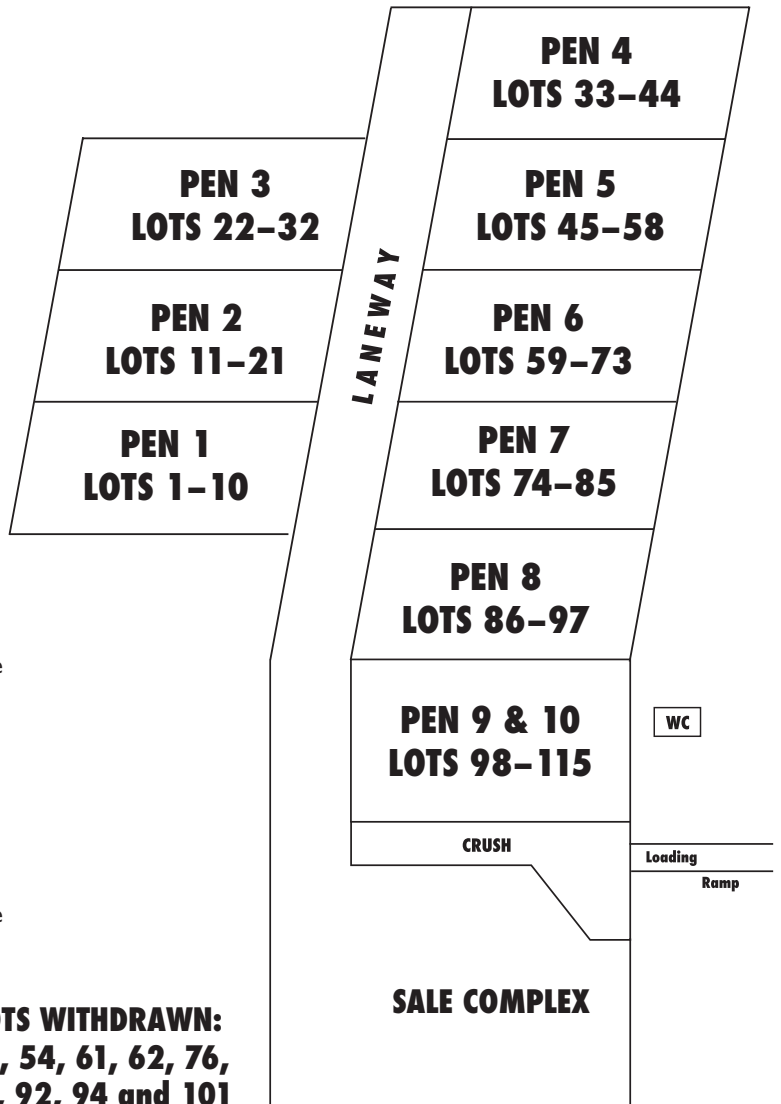

## Updated EBVs for Lot 100:

### Lot 100 BONGONGO U1568<sup>PV</sup> NGX23U1568

Calved: 2/9/2023

Genetic Status: AMF,CAF,DDF,NHF

Reg'n Level: APR

RENNYLEA L519<sup>PV</sup>

BONGONGO M412<sup>PV</sup>

Sire: NGXR974 BONGONGO R974<sup>PV</sup>

Dam: NGXP544 BONGONGO P544<sup>PV</sup>

BONGONGO M845<sup>SV</sup>

BONGONGO M568<sup>SV</sup>

Structural Assessment - August 2024							Temp.	Sheath
F	R	F	R	F	R			
6	5	6	5	5	6	1	5	

#### Mid September 2024 TransTasman Angus Cattle Evaluation

TACE	Calving Ease				Growth					Fertility		Temp	
	Calving Ease Dir	Calving Ease Dtrs	Gest. Length	Birth Wt	200 Day Growth	400 Day Weight	600 Day Weight	Mat. Cow Weight	Milk	Days to Calving	Scrotal Size	Docility	
<b>EBV</b>	<b>+5.9</b>	<b>-1.1</b>	<b>-6.9</b>	<b>+2.6</b>	<b>+44</b>	<b>+83</b>	<b>+103</b>	<b>+79</b>	<b>+18</b>	<b>-8.1</b>	<b>+4.0</b>	<b>+48</b>	
Acc	64%	53%	81%	81%	81%	79%	80%	76%	72%	40%	77%	75%	
Perc	19	85	16	21	79	75	82	83	45	3	6	1	
	Carcass						Feed Efficiency		Structural			Selection Index	
	Carcass Weight	EMA	Rib Fat	Rump Fat	RBV	IMF	NFI-F	Claw Set	Foot Angle	Leg Angle	\$A	\$A-L	
<b>EBV</b>	<b>+44</b>	<b>+2.7</b>	<b>+0.9</b>	<b>+0.3</b>	<b>-0.2</b>	<b>+3.4</b>	<b>+0.98</b>	<b>+0.64</b>	<b>+1.02</b>	<b>+0.96</b>	<b>\$214</b>	<b>\$358</b>	
Acc	67%	67%	67%	68%	58%	72%	59%	61%	61%	61%	-	-	
Perc	96	87	29	39	84	22	98	14	63	29	38	44	

Traits Observed: BWT,400WT,Scan(EMA,Rib,Rump,IMF),Genomics

Statistics: Number of Herds: 0 Prog Analysed: 0